



INSTRUCTION BULLETIN

No. 340459
Machine: ATLV 4300
Published: 12-00/00
System: VACUUMING

NOTE: DO NOT DISCARD the Parts List from the Instruction Bulletin. Place the Parts List in the appropriate place in your machine manual for future reference. Retaining the Parts List will make it easier to reorder individual parts and will save you the cost of ordering an entire kit.

NOTE: Numbers in parenthesis () are reference numbers for parts listed in Bill of Materials.

Installation instructions for kit number 368586

SYNOPSIS / PROBLEM:

This kit contains the parts needed to replace the dust filter housing door latches on the model ATLV 4300 Litter.

Please follow step-by-step instructions.

SPECIAL TOOLS / CONSIDERATIONS: Hand Drill, 3/16" drill bit

(Estimated time to complete: 1 hour)

PREPARATION:

(Refer to FIG. 1, 2 and 3)

FOR SAFETY: Before leaving or servicing machine, stop on level surface and set parking brake. Then turn off machine and remove key.

INSTALLATION:

(Refer to FIG. 1, 2 and 3)

1. Open the dust filter housing and remove the dust filter. Set the dust filter aside.
2. Disconnect the cable ends from the mounting brackets on each side of the filter door.
3. Remove and set aside the filter door. Remove the left and right mounting brackets from the sides of the filter door. Set the mounting bracket hardware aside. Rework the mounting brackets according to the dimensions in the rework drawings. (Refer to FIG. 1, 2 and 3)
4. Remount the brackets to the filter door with the set aside mounting hardware.
(Refer to FIG. 1)
5. Locate the door latches on the right and left hand sides of the filter housing. Drill out the rivets mounting the door latches to the housing, with the 3/16" drill bit. Discard the old mounting latches.
6. Mount the two new door latches (1) with the new rivets (2), and washers (3).
(Refer to FIG. 1)
7. Reinstall the filter door. Reconnect the cable ends to the reworked brackets with the set aside mounting hardware. (Refer to FIG. 1)

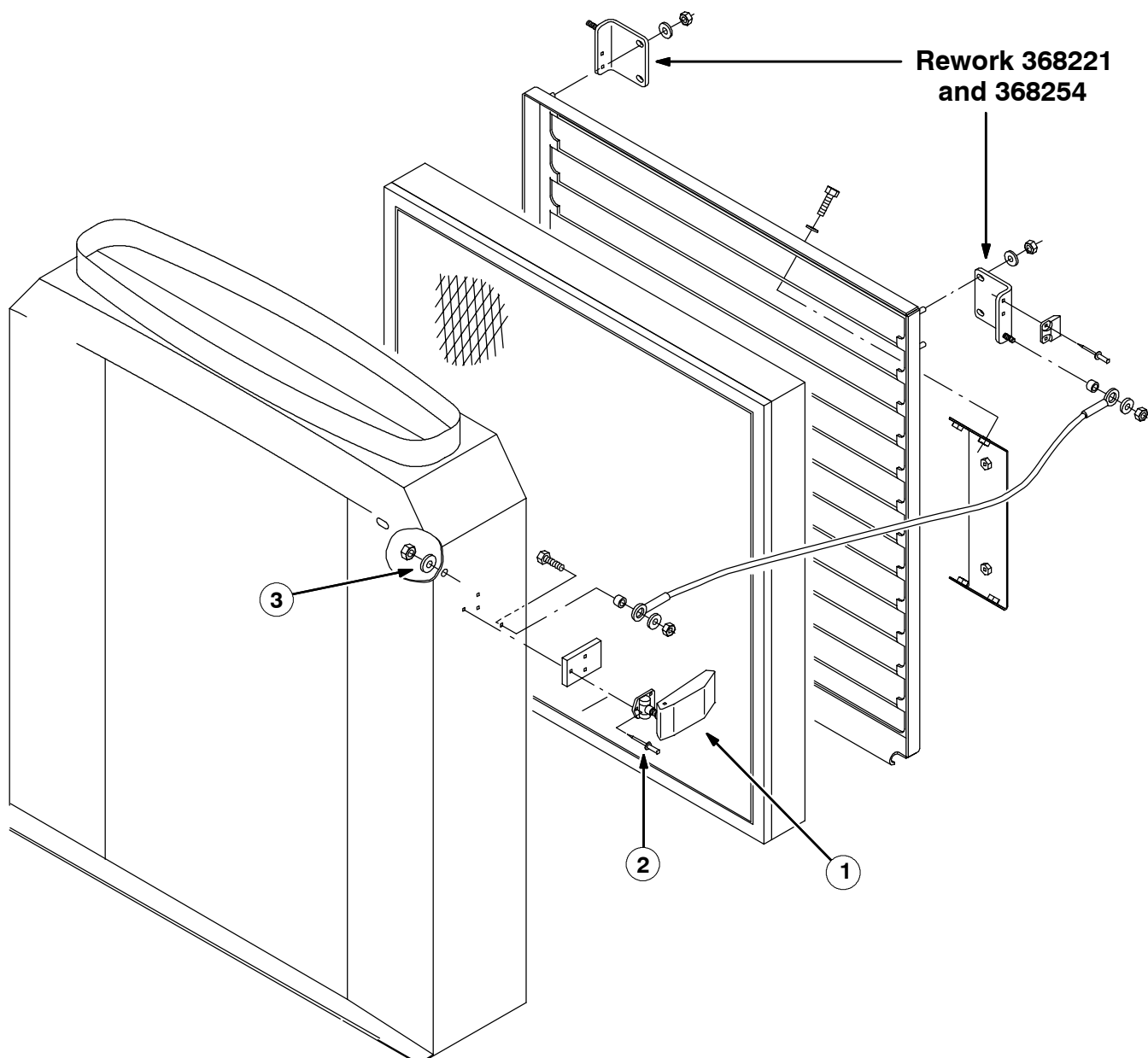

FIG. 1 - NEW FILTER LATCH INSTALLATION

BILL OF MATERIALS FOR FILTER LATCH KIT 368586

Ref.	TENNANT Part No.	Description	Qty.
1	368584	Latch	2
2	763075	Rivet, pop, 0.156D X 0.710L X 0.31D head	8
3	41579	Washer, flt, #08 Ss	4

TENNANT COMPANY
P. O. Box 1452
Minneapolis, MN 55440-1452

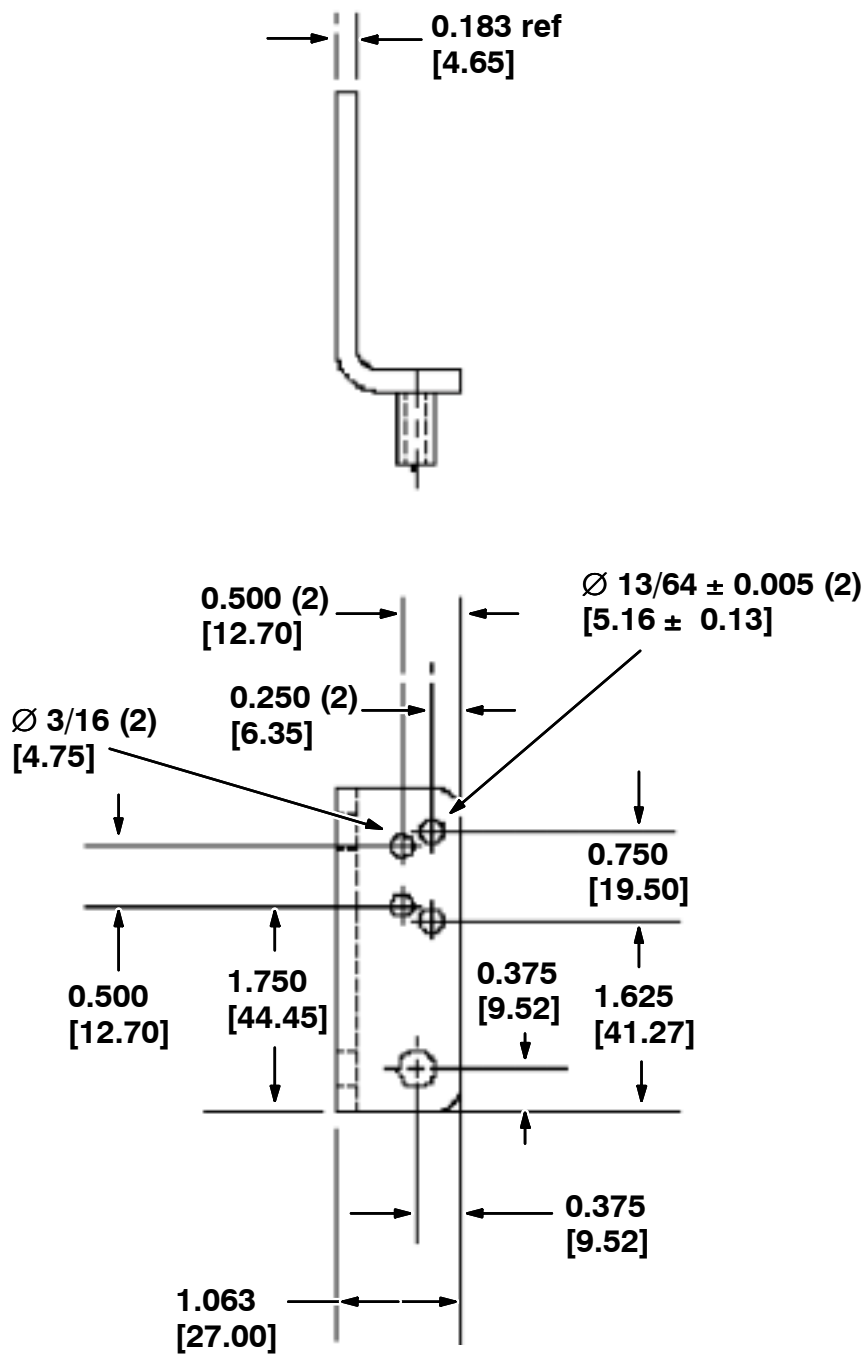
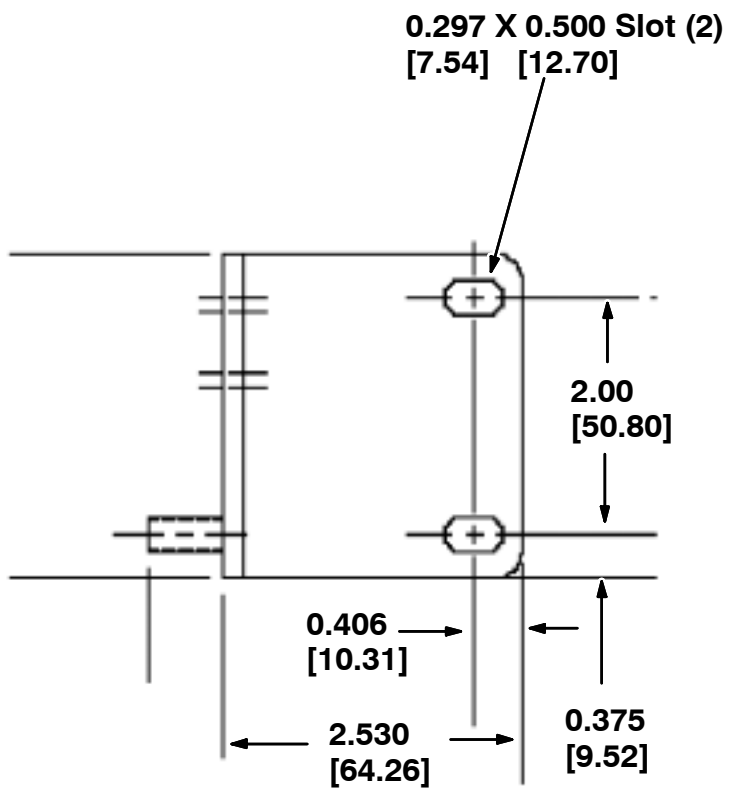

FIG. 2 - RIGHT HAND MOUNTING BRACKET REWORK

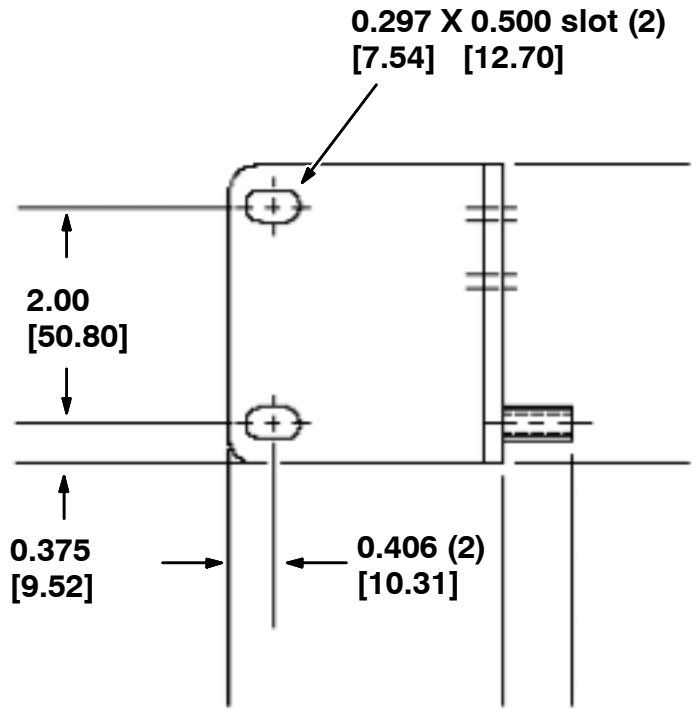
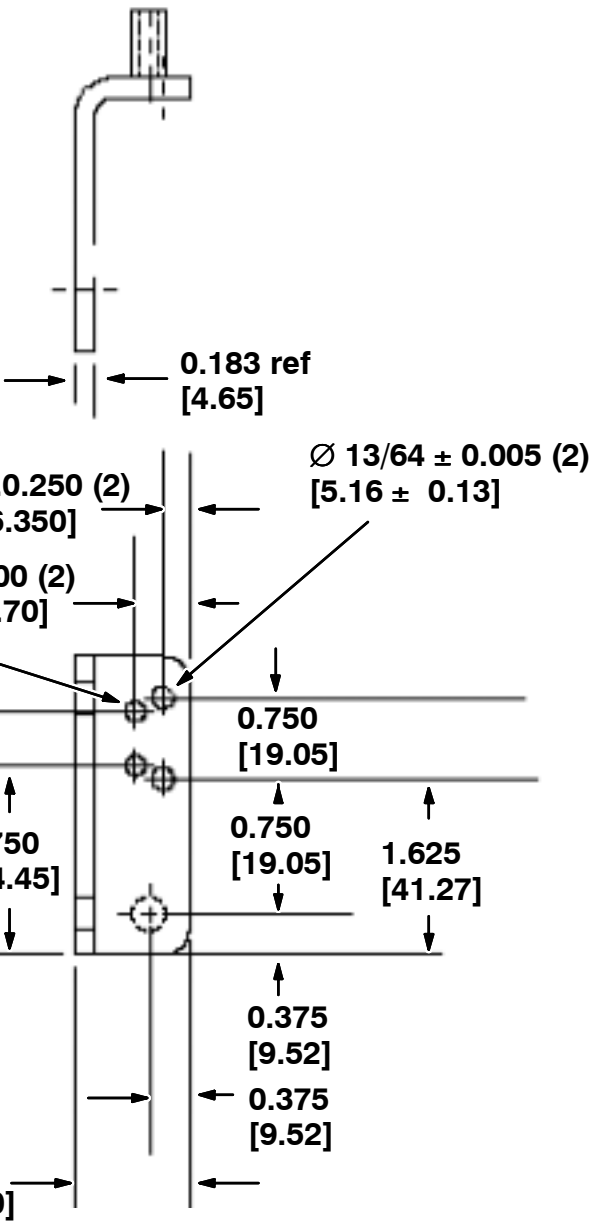

FIG. 3 - LEFT HAND MOUNTING REWORK